

## BEFORE OPERATING:

The Aurand cleaning tool (electric model) is equipped with a universal type motor which is equally efficient on either direct or alternating current. It is furnished for use with either 115 or 230 voltage, **Both voltages are NOT possible on one machine.** The voltage for your machines is stamped on the name plate.

The M tool has been thoroughly tested and shipped complete, but **DO NOT** attempt to operate without reading the following instructions.

## OPERATING INSTRUCTIONS:

1. Wear safety glasses and hearing protection.
2. Grasp both handles and raise front of tool from surface.
3. Squeeze trigger and allow cutters to come up to speed before applying to surface.
4. Using both hands, guide tool in a forward and backward motion to assure complete coverage. Let weight of tool do the work. Never apply pressure as this will slow down motor speed and cause damage to motor, gears, and cutter bundles.

## DEPTH ADJUSTMENT:

When adjustment is required to compensate for cutter wear:

1. Loosen SCREW (Ref 7M)
2. Move DEPTH SHOE (Ref 6M) up or down as required. (Cutters should have play in them when touching work surface)
3. Tighten SCREW (Ref 7M)

## CUTTER BUNDLE REPLACEMENT:

1. Install COTTER PIN & WASHER (Ref 2M) on both ends of SPINDLE (Ref 24M-1 or 24ME-1). Cutter tips must point in direction of rotation.
2. Slide CUTTER BUNDLE (Ref 90M) and CUTTER BUNDLE FELT (Ref 29M) from SPINDLE.
3. Slide new CUTTER BUNDLE FELT & CUTTER BUNDLES on SPINDLE, with large round hole facing side plate. CUTTER TIPS must point in direction of rotation.
4. Install COTTER PINS & WASHER on both ends of SPINDLE.

## LUBRICATION:

Check oil (1245) in Gear Housing after every 9 hours of operation . Remove Oil Screw (Ref 4M). With tool sitting level add 1245 Gear Oil through hole. Then replace SCREW & PLUG.

## Aurand Manufacturing & Equipment Company

1210 Ellis St  
Cincinnati OH 45223-1843

800-860-2872 or 513-541-7200  
Fax 513-541-3065

[www.aurand.net](http://www.aurand.net)

We gladly accept:



# AURAND



## M5-1, M5-2 M5-1E, M5-2E

## Parts List & Operating Instructions

# AURAND

**Aurand has manufactured exclusively in the USA since 1937.**

# AURAND

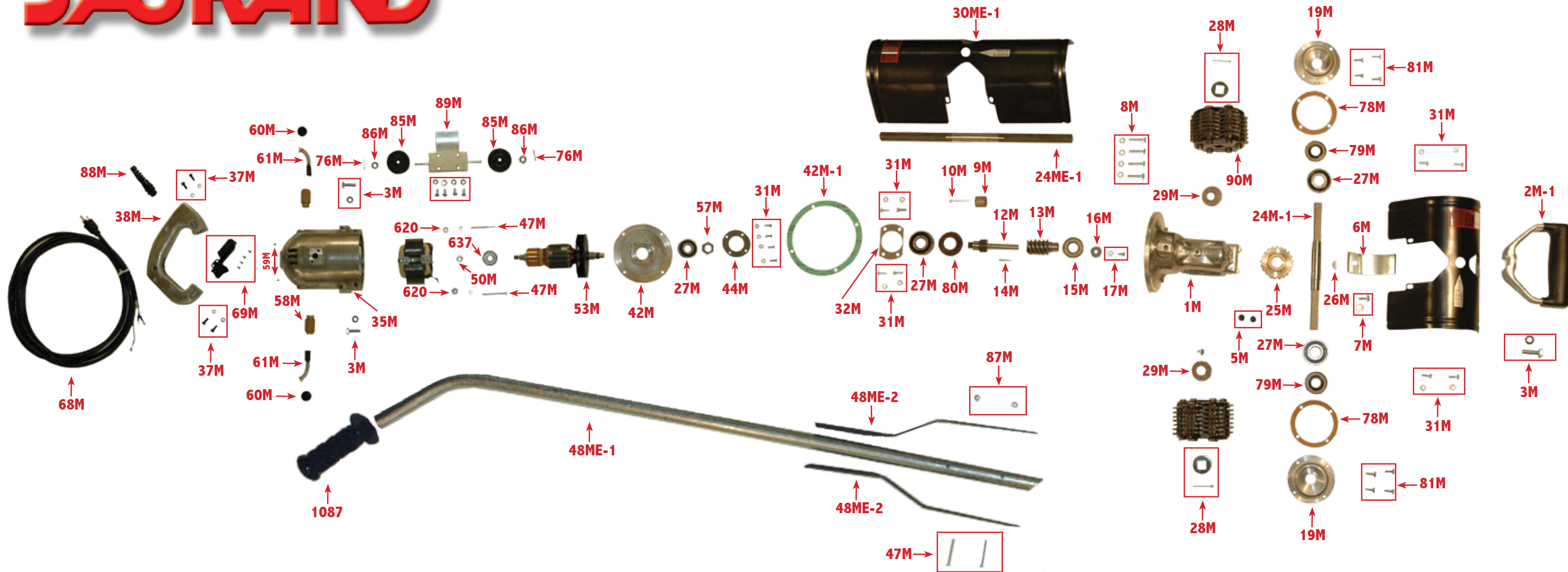

## PART NUMBERS

620	Washer (2)	12M	Worm Shaft	28M	Cutter Key & Washer	46M	Motor Field (115 Volt)	69M	Switch	<b>48ME Handle Assembly</b> (Standard on Models M5-1E & M5-2E Optional on Models M5-1 & M5-2)
637	Bearing	13M	Worm	29M	Cutter Bundle Felt (2)	246M	Motor Field (230 Volt)	76M	Cotter Pin (2)	
1M	Front Housing	14M	Worm Key	30M-1	Guard 8"	47M	Screw & Washer (2)	78M	Side Plate Gasket (2)	
2M-1	Spade Handle	15M	Bearing -Worm Shaft	30ME-1	Guard 12" (not shown)	50M	Armature Nut	79M	Shaft Seal (2)	
3M	Handle Screw & Washer (3)	16M	Worm Shaft Washer	31M	Screw & washer (12)	53M	Motor Armature (115 Volt)	80M	Rear Bearing Gasket	
4M	Screw	17M	Worm Shaft Screw & Washer	32M	Housing BRG. Plate	253M	Motor Armature (230 Volt)	81M	Side Plate Seal Screw (8)	
5M	Boss Plug (2)	19M	Side Plate (2)	35M	Motor Housing	57M	Armature Nut	85M	Wheel (2)	
6M	Depth Shoe	24M-1	Cutter Spindle 8"	37M	Handle Screw & Washer	58M	Brush Holder (2)	86M	Washer (2)	
7M	Screw & Washer	24ME-1	Cutter Spindle 12" (not shown)	38M	Rear Handle	59M	Holder Set Screw (2)	88M	Cable Protector	
8M	Front ASG Screw (4)	25M	Worm Wheel	42M	Center Plate	60M	Holder Cap (2)	89M	Bracket	
9M	coupling	26M	Woodruff Key	42M-1	Center Plate Gasket	61M	Motor Brush (2)	90M	Cutter Bundle Set	
10M	Cotter Pin	27M	Bearing (4)	44M	Bearing Plate	68M	Lead Wire	90ME	Cutter Bundle Set (not shown)	
								1245	Oil 8 Oz. Tube	