

BEFORE OPERATING:

The Aurand cleaning tool (electric model) is equipped with a universal type motor which is equally efficient on either direct or alternating current. It is furnished for use with either 115 or 230 voltage, **Both voltages are NOT possible on one machine.** The voltage for your machines is stamped on the name plate.

The M tool has been thoroughly tested and shipped complete, but **DO NOT** attempt to operate without reading the following instructions.

OPERATING INSTRUCTIONS:

1. Wear safety glasses and hearing protection.
2. Grasp both handles and raise front of tool from surface.
3. Squeeze trigger and allow cutters to come up to speed before applying to surface.
4. Using both hands, guide tool in a forward and backward motion to assure complete coverage. Let weight of tool do the work. Never apply pressure as this will slow down motor speed and cause damage to motor, gears, and cutter bundles.

DEPTH ADJUSTMENT:

When adjustment is required to compensate for cutter wear:

1. Loosen SCREW (Ref 7M)
2. Move DEPTH SHOE (Ref 6M) up or down as required. (Cutters should have play in them when touching work surface)
3. Tighten SCREW (Ref 7M)

CUTTER BUNDLE REPLACEMENT:

1. Install COTTER PIN & WASHER (Ref 2M) on both ends of SPINDLE (Ref 24M-1 or 24ME-1). Cutter tips must point in direction of rotation.
2. Slide CUTTER BUNDLE (Ref 90M) and CUTTER BUNDLE FELT (Ref 29M) from SPINDLE.
3. Slide new CUTTER BUNDLE FELT & CUTTER BUNDLES on SPINDLE, with large round hole facing side plate. CUTTER TIPS must point in direction of rotation.
4. Install COTTER PINS & WASHER on both ends of SPINDLE.

LUBRICATION:

Check oil (1245) in Gear Housing after every 9 hours of operation . Remove Oil Screw (Ref 4M). With tool sitting level add 1245 Gear Oil through hole. Then replace SCREW & PLUG.

Aurand Manufacturing & Equipment Company

1210 Ellis St
Cincinnati OH 45223-1843

800-860-2872 or 513-541-7200
Fax 513-541-3065

www.aurand.net

We gladly accept:



AURAND



M5-1, M5-2 M5-1E, M5-2E

Parts List & Operating Instructions

AURAND

Aurand has manufactured exclusively in the USA since 1937.

AURAND

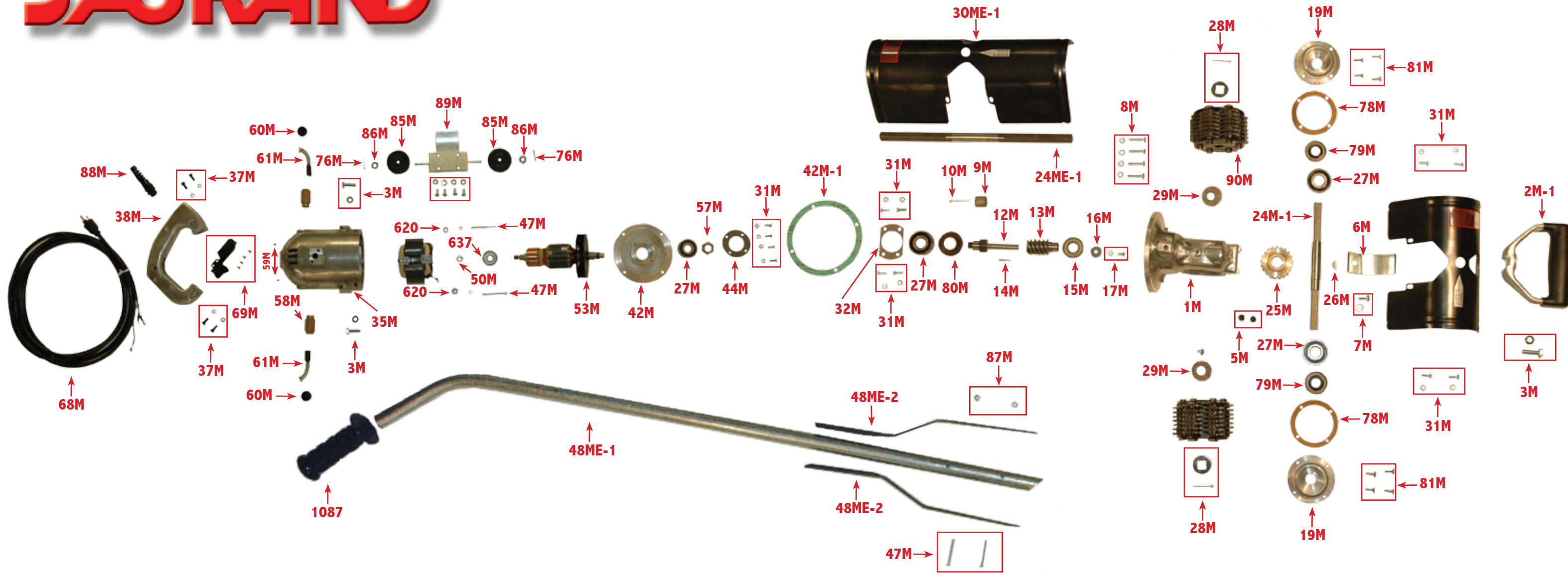

PART NUMBERS

| | | | | | | | | | | |
|------|---------------------------|--------|--------------------------------|--------|------------------------|------|---------------------------|------|-------------------------------|---|
| 620 | Washer (2) | 12M | Worm Shaft | 28M | Cutter Key & Washer | 46M | Motor Field (115 Volt) | 69M | Switch | 48ME Handle Assembly (Standard on Models M5-1E & M5-2E Optional on Models M5-1 & M5-2) |
| 637 | Bearing | 13M | Worm | 29M | Cutter Bundle Felt (2) | 246M | Motor Field (230 Volt) | 76M | Cotter Pin (2) | |
| 1M | Front Housing | 14M | Worm Key | 30M-1 | Guard 8" | 47M | Screw & Washer (2) | 78M | Side Plate Gasket (2) | |
| 2M-1 | Spade Handle | 15M | Bearing -Worm Shaft | 30ME-1 | Guard 12" (not shown) | 50M | Armature Nut | 79M | Shaft Seal (2) | |
| 3M | Handle Screw & Washer (3) | 16M | Worm Shaft Washer | 31M | Screw & washer (12) | 53M | Motor Armature (115 Volt) | 80M | Rear Bearing Gasket | |
| 4M | Screw | 17M | Worm Shaft Screw & Washer | 32M | Housing BRG. Plate | 253M | Motor Armature (230 Volt) | 81M | Side Plate Seal Screw (8) | |
| 5M | Boss Plug (2) | 19M | Side Plate (2) | 35M | Motor Housing | 57M | Armature Nut | 85M | Wheel (2) | |
| 6M | Depth Shoe | 24M-1 | Cutter Spindle 8" | 37M | Handle Screw & Washer | 58M | Brush Holder (2) | 86M | Washer (2) | |
| 7M | Screw & Washer | 24ME-1 | Cutter Spindle 12" (not shown) | 38M | Rear Handle | 59M | Holder Set Screw (2) | 88M | Cable Protector | |
| 8M | Front ASG Screw (4) | 25M | Worm Wheel | 42M | Center Plate | 60M | Holder Cap (2) | 89M | Bracket | |
| 9M | coupling | 26M | Woodruff Key | 42M-1 | Center Plate Gasket | 61M | Motor Brush (2) | 90M | Cutter Bundle Set | |
| 10M | Cotter Pin | 27M | Bearing (4) | 44M | Bearing Plate | 68M | Lead Wire | 90ME | Cutter Bundle Set (not shown) | |
| | | | | | | | | 1245 | Oil 8 Oz. Tube | |